

上海碧珑机械有限公司
Shanghai Belon Machinery Co.,Ltd



全国专业齿轮（零件）制造的领先者之一
Leading Manufacturer Of Gears & Shafts Nationally

企业简介 Company presentation

Application Industries



Automotive



Agriculture



Oil & Gas



Robotics



Automation



Mining & Aggregate



Cement



Metallurgy

Cylindrical Gear

Spur gear ,Helical gear ,Internal gear ,Herringbone gear



Hobbing 滚齿



Milling 铣齿



Milling 铣齿



Grinding 磨齿



Grinding 磨齿

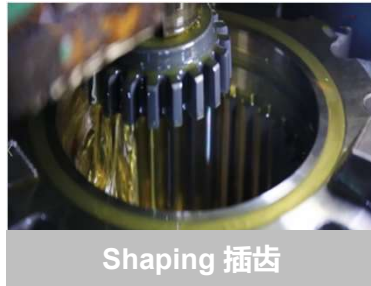

Shaping 插齿



Broaching 拉齿

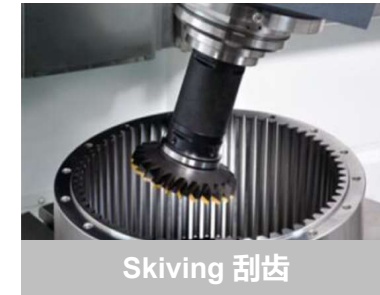

Skiving 刮齿

Different machining capacity		Hobbing / grinding spur or helical	Milling /grinding spur or helical	Milling /grinding Internal	Shaping Internal	Broaching internal	Skiving internal
Diameter (mm)	直径范围	~Φ2500	~Φ2500	~Φ2500	~Φ2500	N.A	
Module (mm)	模数范围	1~45	1~45	1~45	1~45	N.A	
Tooth Grade	精度等级	ISO 8 ~ ISO 10 Hobbing ISO 4~ ISO 7 Grinding	ISO 8 ~ ISO 10 Milling ISO 4~ ISO 7 Grinding	ISO 8 ~ ISO 10 Milling ISO 4~ ISO 7 Grinding	≥ ISO 8	≥ ISO 7	≥ ISO 4
Tooth Finish	齿面精度	Ra3.2/ Ra0.8	Ra3.2/Ra0.8	Ra3.2/Ra0.8			
Helix Angle	螺旋角	±45°	±45°	±22.5			

Bevel Gear

Straight bevel gear ,Spiral bevel gear , Hypoid gear ,Crown gear



Milling 铣齿



Lapping 研齿



Grinding 磨齿

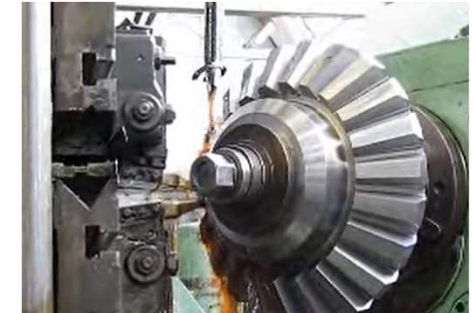

Broaching 刨齿

		Milling /Grinding Gleason bevel gears	Milling/Grinding Klingelnberg bevel gear	Lapping	Broaching
Diameter (mm)	直径范围	Φ10~Φ2000	Φ20~Φ2500	Φ10~Φ3000	Φ80~Φ3000
Module (mm)	模数范围	0.5~30	3~45	3~45	3~45
Tooth Grade	精度等级	ISO 8 ~ ISO 10 Milling ISO 5~ ISO 6 Grinding	ISO 8 ~ ISO 10 Milling ISO 5~ ISO 6 Grinding	ISO7~ISO8 without changing accuracy	ISO 8 ~ ISO 9
Roughness	齿面粗糙度	Ra0.6 grinding	Ra0.6 grinding	Ra3.2	Ra3.2

Well Prepared Greatly Improved

+12 years of the precipitation and accumulation make it possible for Belon Machinery to supply the TOP quality GEARS, SHAFTS, and SERVICES. All key partners are ISO 9001, IATF 16949, ISO 14001 certified.



Gears for Automotive



Gears for Industrial Robot



Gears for Aviation



Gears for Agriculture



Gears for Oil & Gas





Racks for Automation and Machineries

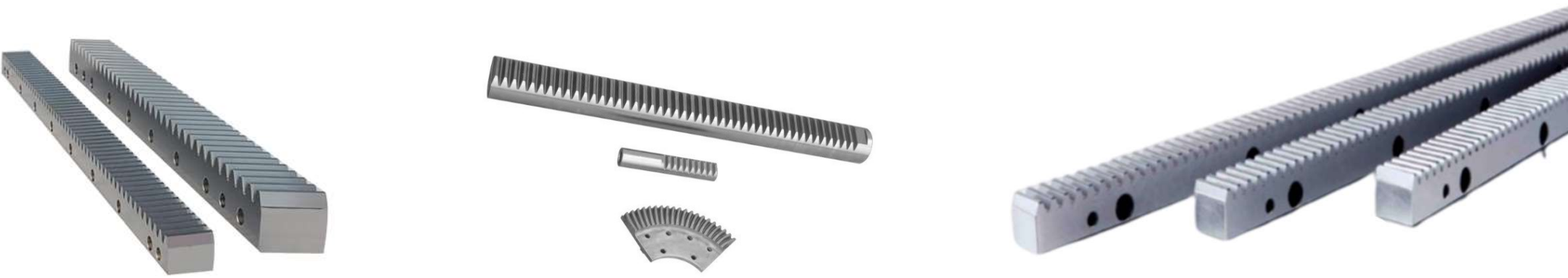

Gears for Mining & Aggregate



| Worm Gears

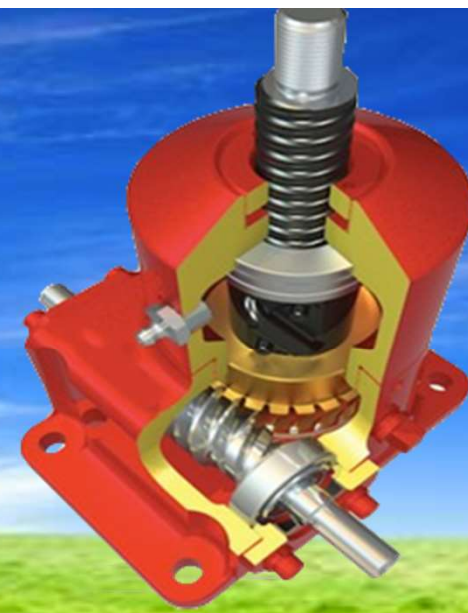

Regular Materials

Carbon Steel , Alloy steel , Stainless steel ,casting bronze ,Brass etc...

GB	JIS	ASTM/AISI	DIN	Delivery Status	Tensile Strength N/mm2(Min)	Elongation %	Hardness without surface hardening HB	Regular Hardening	Hardness after hardening (HRC)
42CrMo	SCM440	4140	42CrMo4 (1.7225)	Tempering +Quenching	> 1080	> 12	229	Induction hardening + tempering	> 56 HRC
20	S20CK	1020	CK22(1.1151), C22E	Normalizing /Tempering+Quenching	> 450	> 23	170	Carburizing, carbonitriding + quenching + tempering	> 56 HRC
45	S43C / S45C	1045	Ck45 (1.1191) C45E	Normalizing /Tempering+Quenching	> 600	> 16	229	Induction hardening + tempering	>55 HRC
16CrMnH	N.A	N.A	16MnCr5 (1.7131)	Tempering+Quenching	> 720	> 10		Carburizing, carbonitriding + quenching + tempering	> 56 HRC
20CrMo	SCM 420H / 418	4118	20CrMo5 (1.7264)	Tempering+Quenching	> 885	> 12	197	Carburizing, carbonitriding + quenching + tempering	> 56 HRC
20CrMn	SMnC420	N.A	20MnCr5 (1.7147)	Tempering+Quenching	> 930	> 10	187	Carburizing, carbonitriding + quenching + tempering	> 56 HRC
17Cr2Ni2Mo (锻造)	N.A	N.A	18CrNiMo7-6 (1.6587)	Tempering+Quenching	> 980	> 10		Carburizing, carbonitriding + quenching + tempering	> 56 HRC

Regular Materials

Carbon Steel , Alloy steel , Stainless steel ,casting bronze ,Brass etc...

GB	JIS	ASTM/AISI	DIN	Delivery Status	Tensile Strength N/mm2(Min)	Elongation %	Hardness without surface hardening HB	Regular Hardening	Hardness after hardening (HRC)
20CrNiMo	SNCM 220	8620	21NiCrMo2 (1.6523)	Tempering+Quenching	> 980	> 9	197	Carburizing, carbonitriding + quenching + tempering	> 56 HRC
20CrMnTi	N/A	N/A	N/A	Tempering+Quenching	> 1080	> 10	217	Carburizing, carbonitriding + quenching + tempering	> 56 HRC
20CrMnMo	N/A	N/A	N/A	Tempering+Quenching	> 1180	> 10	217	Carburizing, carbonitriding + quenching + tempering	> 56 HRC
34Cr2Ni2Mo	N.A	N.A	34CrNiMo6 (1.6582)	Tempering+Quenching	> 1080	> 10	269	Induction hardening + tempering	> 56 HRC
35CrMo	SCM 435	4135 / 4137	34CrMo4 (1.7220)	Tempering+Quenching	> 980	> 12	229	Induction hardening + tempering	> 56 HRC
40CrNiMoA	SNCM 439	4340	36CrNiMo4 (1.6511)	Tempering+Quenching	> 980	> 12	269	Induction hardening + tempering	> 56 HRC
40Cr	SCr 440	5140	41Cr4 (1.7035)	Tempering+Quenching	> 980	> 9	207	Nitriding, nitrocarburizing + quenching + tempering	43-53 HRC
42CrMo	SCM 440	4140	42CrMo4 (1.7225)	Tempering+Quenching	> 1080	> 12	229	Induction hardening + tempering	> 56 HRC

Quality Control Process

质量控制流程

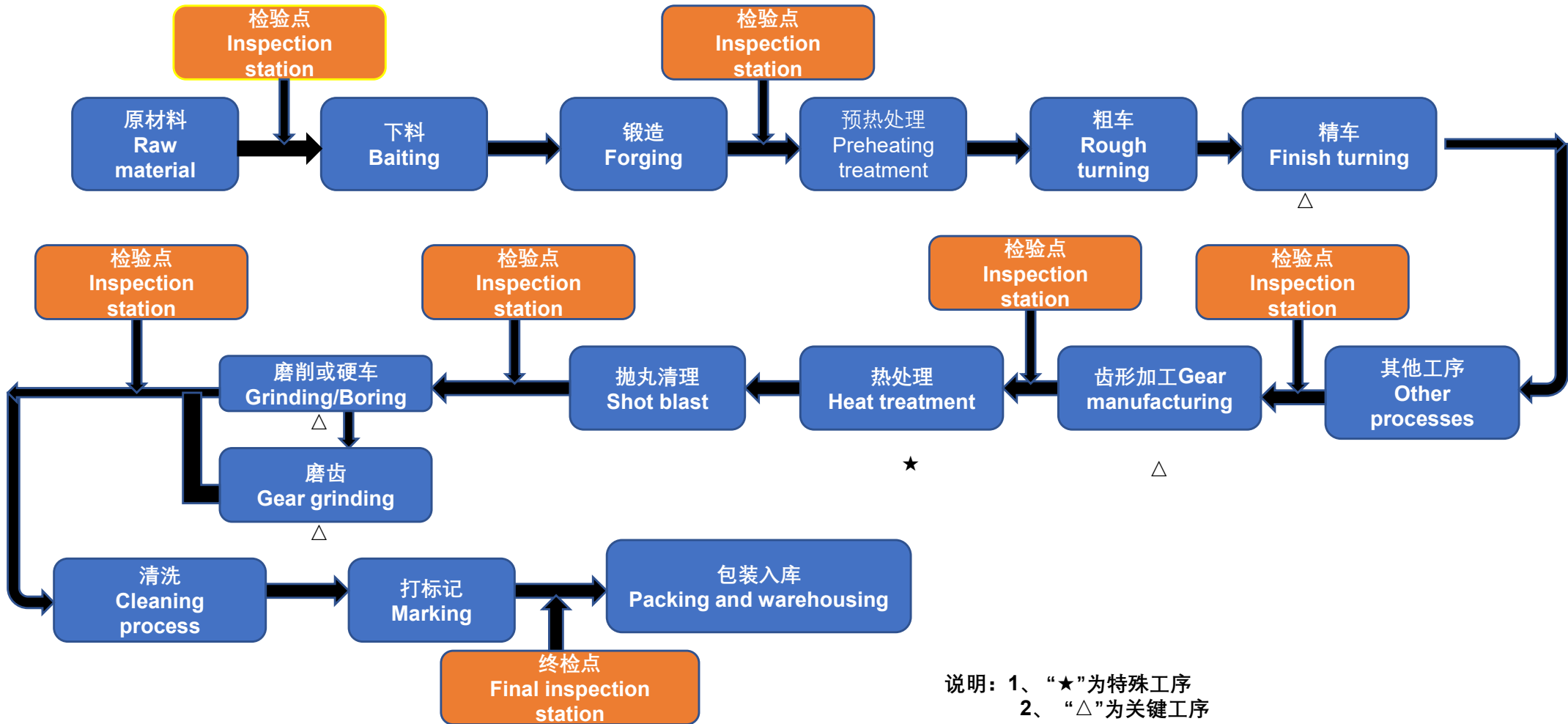

说明：1、“★”为特殊工序
2、“△”为关键工序

please note: The mark of “★” is special process.
The mark of “△” is key process.

Key Control Process



1. Raw Material

- ◆ Chemical specification and Heat number



2. Heat Treatment

- ◆ Mechanical Property and Lot Number

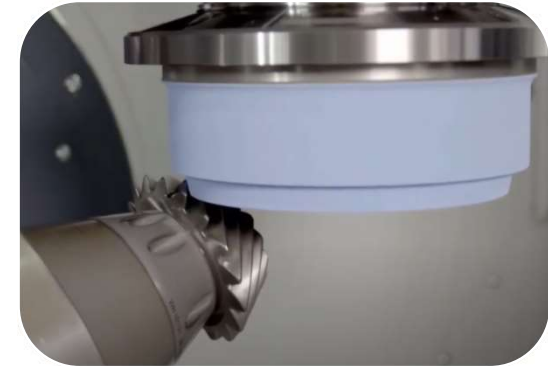

3. Machining

- ◆ Equipment, Cutter, Program, Dimension



4. Gear Inspection

- ◆ Accuracy Grade



5. Functional Check

- ◆ Meshing

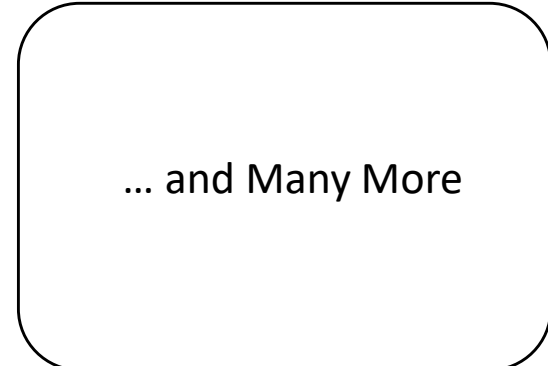

6. More

- ◆ Crack ...

Well Organized Workshop and Heat Treat

车间和热处理



Well Organized Workshop



Well Organized Heat Treat

Good Employees + Good Company → Good Products

Adhering to the spirit of customer first, to provide customers with satisfactory products and services. Continuous improvement and pursuit of excellence to go beyond customers expect.

Do not accept defective products

Do not flow defective products to the next process

Do not produce defective products

Do not send defective products



Service System



Our supports and services will accompany you all the way through the whole cycle of product design, production and after-sales. With our packaged professional knowledge and experience, Belon Machinery will provide you with fast and premium service guarantee.



Engineering Support
We are supportive to our customers for both new design and update of regular product.



Rapid Service
we promise to respond to customer request within 2 hours during work time. We update order status to our customers on every Friday.



Logistics Support
We continuously improve safe package, clear mark and cost saving for our customers.



上海碧珑机械有限公司
Shanghai Belon Machinery Co.,Ltd

 Lolita@belongear.com

 www.belongear.com

 <https://www.linkedin.com/company/belongear-manufacture>

 <https://www.youtube.com/c/ShanghaiBelonMachineryColtd>

 <https://www.facebook.com/belongear/>

 <https://twitter.com/belongear>



Address

Bajie Factory, 2nd Floor, Building C3,
Internet Baodi, No.221, HuangXing Road,
Yangpu District, Shanghai, China



E-mail

lolita@belongear.com
jun.z@belongear.com



Phone

86-18721953851



Hours

Monday-Friday: 9am to 6pm
Saturday, Sunday: Closed